

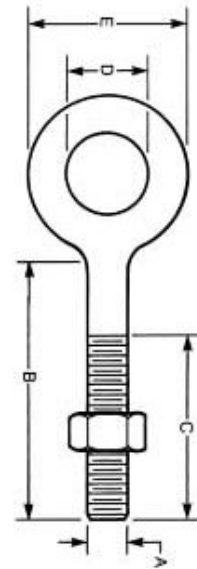

REGULAR EYE BOLTS - GALVANIZED

"A" Bolt Dia. (in.)	"B" Shank Length (in.)	Working Load Limit in Lbs.	Approx. Wt. in Lbs.	C	D	E
1/4"	2"	650	0.06	1.50	0.50	1.00
1/4"	4"	650	0.10	2.50	0.50	1.00
5/16"	2 1/4"	1200	0.13	1.50	0.63	1.25
5/16"	4 1/4"	1200	0.17	2.50	0.63	1.25
3/8"	2 1/2"	1500	0.22	1.50	0.75	1.50
3/8"	4 1/2"	1500	0.28	2.50	0.75	1.50
3/8"	6"	1500	0.33	2.50	0.75	1.50
1/2"	2"	2600	0.46	1.50	1.00	2.00
1/2"	3 1/4"	2600	0.54	1.50	1.00	2.00
1/2"	6"	2600	0.68	3.00	1.00	2.00
1/2"	8"	2600	0.80	3.00	1.00	2.00
1/2"	10"	2600	0.93	3.00	1.00	2.00
1/2"	15"	2600	1.23	5.00	1.00	2.00
5/8"	4"	5200	1.00	2.00	1.25	2.50
5/8"	6"	5200	1.14	3.00	1.25	2.50
5/8"	8"	5200	1.38	3.00	1.25	2.50
5/8"	10"	5200	1.55	3.00	1.25	2.50
5/8"	12"	5200	1.69	4.00	1.25	2.50
3/4"	4 1/2"	7200	1.64	2.00	1.50	3.00
3/4"	6"	7200	1.81	3.00	1.50	3.00
3/4"	8"	7200	2.00	3.00	1.50	3.00
3/4"	10"	7200	2.30	3.00	1.50	3.00
3/4"	12"	7200	2.50	4.00	1.50	3.00
3/4"	15"	7200	2.90	5.00	1.50	3.00
1"	6"	10000	3.60	3.00	2.00	4.00
1"	9"	10000	4.30	4.00	2.00	4.00
1"	12"	10000	5.00	4.00	2.00	4.00



⚠ Never Exceed Working Load Limit

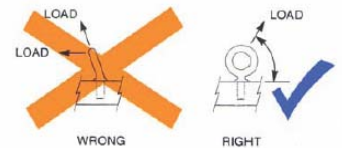

SHOULDER EYE BOLTS - GALVANIZED

"A" Bolt Dia. (in.)	"B" Shank Length (in.)	Working Load Limit in Lbs.	Approx. Wt. in Lbs.	C	D	E
1/4"	2"	650	0.06	1.50	0.50	0.88
1/4"	4"	650	0.09	2.50	0.50	0.88
5/16"	2 1/4"	1200	0.11	1.50	0.63	1.13
5/16"	4 1/4"	1200	0.15	2.50	0.63	1.13
3/8"	2 1/2"	1500	0.19	1.50	0.75	1.38
3/8"	4 1/2"	1500	0.25	2.50	0.75	1.38
1/2"	3 1/4"	2600	0.41	1.50	1.00	1.75
1/2"	6"	2600	0.59	3.00	1.00	1.75
5/8"	4"	5200	0.83	2.00	1.25	2.25
5/8"	6"	5200	1.00	3.00	1.25	2.25
3/4"	4 1/2"	7200	1.50	2.00	1.50	2.75
3/4"	6"	7200	1.70	3.00	1.50	2.75

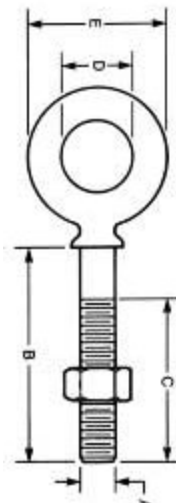

⚠ Never Exceed Working Load Limit







EYEBOLTS—TYPE 304 STAINLESS

Formed and welded. Comes with nut and washer.

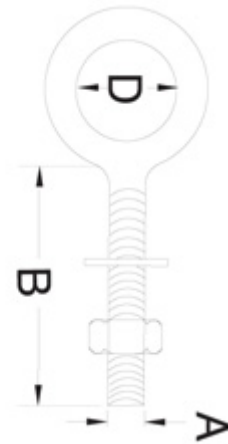
Size (A)	B	D	W.L.L. (lbs.)	Wt. Ea. (lbs.)
1/4"	2-3/8"	3/8"	400	0.04
1/4"	3-3/16"	3/8"	400	0.05
5/16"	3-3/16"	1/2"	600	0.1
5/16"	4"	1/2"	600	0.12
3/8"	4"	5/8"	1000	0.18
3/8"	6"	5/8"	1000	0.28
1/2"	4"	3/4"	1800	0.36
1/2"	6"	3/4"	1800	0.45



 Never Exceed Working Load Limit

